

Dual Medium Intensity Type C Obstruction Light
(1 duty & 1 stand-by)

Welcome to use our products, please read the product manual before use.

1. Product Overview

- a) Product features: low power consumption, easy installation, and small size.
- b) Main purpose and scope of application: Suitable for installation on fixed buildings and structures, such as power towers, communication towers, chimneys, high-rise buildings, large bridges, large port machinery, large construction machinery, wind turbines and other obstacles Play a warning role.
- c) Variety specifications: C-type medium-intensity aviation obstruction light (double obstruction light, 1 duty & 1 stand-by, steady-burning)
- d) Operating environment conditions:
- Working temperature: $-40\text{ }^{\circ}\text{C} \text{ --- } +55\text{ }^{\circ}\text{C}$;
 - relative humidity: $0\% \sim 95\%$;
 - Wind: no more than 240km / h ;
 - Rain: exposed to rain in any wind direction;
 - Salt fog: exposure to salt fog environment;
 - Radiation: exposure to solar radiation.
- e) Working conditions: Input voltage: $\text{AC}220\text{V} \pm 20\%$ Frequency: $50\text{HZ} / 60\text{HZ}$

2. Precautions

- All wiring must be connected strictly in accordance with the wiring diagram, otherwise the lamp may be damaged, please check the signs and instructions carefully.
- The power supply of this type of controller is $\text{AC}220\text{V} \pm 20\%$, $50\text{HZ} / 60\text{HZ}$. It is strictly forbidden to use other power sources, such as $\text{AC}380\text{V}$, otherwise it will damage the lamps.
- Avoid installation at the top and edges of the building. If it is installed on the top floor of a building, the ground wire should be connected to a lightning protection zone, or a lightning rod should be installed to prevent lightning strikes.
- When the product is working, it is strictly forbidden to open any part of the lamp body to prevent danger.
- This product has a temperature rise during operation, which is normal.
- This product is sealed structure. Non-professional maintenance personnel are not allowed to disassemble and install it. Once found, the company will not guarantee it.

3. Structural characteristics

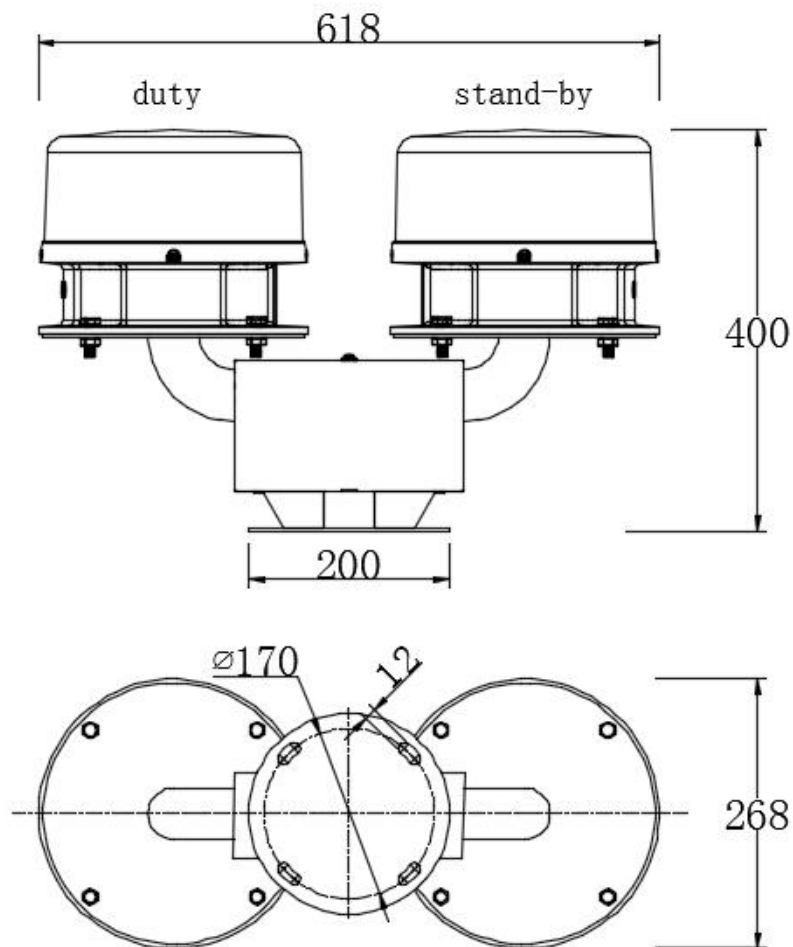

4. Technical characteristics

a) Main performance

- The lampshade is made of anti-UV (ultraviolet) PC (polycarbonate) material, with a transparency of more than 95%. With flame retardant, non-toxic, excellent electrical insulation, dimensional stability, corrosion resistance, high temperature resistance and cold resistance.
- SUS304 stainless steel box base. Aluminum alloy lamp holder, high structural strength, sprayed outdoor protective powder on the surface, anti-UV, anti-corrosion.
- Reflector designed based on the principle of reflection, the light utilization rate is more than 95%, at the same time, it can make the light angle more accurate, the visible distance is farther, and completely eliminate light pollution.
- The light source uses LED cold light source with high efficiency, low power consumption, long life and high brightness.
- The control system based on a single-chip computer can automatically identify the synchronization signal without distinguishing the main and auxiliary lights, and can be controlled by the controller.
- The power supply is designed to be equal to the power supply voltage synchronization signal level and integrated into the power cable to eliminate damage caused by incorrect installation.
- The optical sensor uses a light-sensitive probe that conforms to the natural light spectral curve, which can accurately control the automatic switching of the lamp.
- Lightning protection: the built-in surge protection device makes the circuit more reliable.
- The whole set of lamps and lanterns adopt the full-encapsulation process, which is resistant to shock, vibration and corrosion, and can be used for a long time in harsh environments. Light and firm structure and simple installation.
- The modified product is composed of two obstruction lights, one main light and one backup light. The backup light is used as a backup and is automatically put into use when the main light fails.

b) Main parameters

Item Name	Dual Medium Intensity Type C Obstruction Light(1 duty & 1 stand-by)
Size	618mm*400mm*268mm
Light Source	LED
Emitting Color	Red
Flashing Frequency	Steady-Burning
Beam Angle	Horizontal360°,Vertical $\geq 3^\circ$

Light Intensity	2000cd±25%,Night(<50cd/m2), Dusk, dawn and day are not applicable
Power consumption	≤20W
Life Span	≥100000
Ingress protection	IP65
Lightning protection level	10kA
Weight	18.5kg
Installation Size	Φ170mm -4*M10
Environment Humidity	0%~95%
Operating temperature	-40℃----+55℃
Wind load	240km/h

5. Installation and adjustment

a) Installation conditions and precautions

- This light is a horizontal installation type. Do not install the light obliquely, vertically or vertically.
- When installing, please ensure that the mounting plane of the lamp has sufficient strength.
- When installing, do not point the light-sensitive probe towards a nearby light source, and it should not be blocked by nearby objects.

b) Installation icon

The installation method of this product is the following installation method.

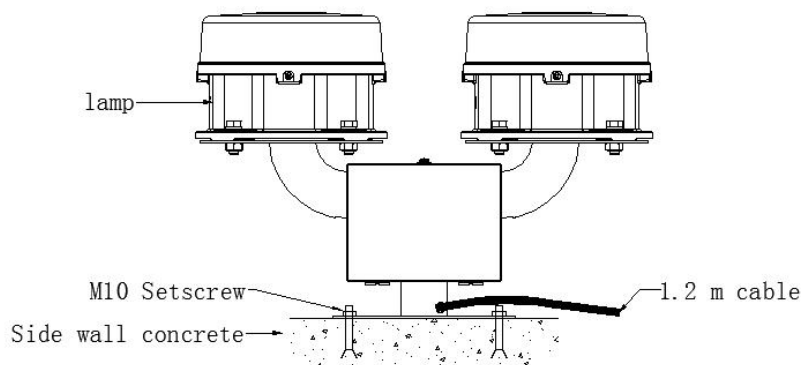

6. Operation

a) Distinction of thread ends

This model of lamp is equipped with a 3-core cable.

Brown Live wire (L) Black Naught wire (N) Blue Signal wire (X) Yellow Earth wire (E)

b) Wiring instructions for multiple lamps and controllers

The wiring of the lamp controlled by the controller is shown in the following figure:

Controller output:

The lamp (brown wire L) is connected to the controller terminal (Live Wire L)
 The lamp (black wire N) is connected to the controller terminal (Naught Wire N)
 The lamp (blue wire X) is connected to the controller terminal (Signal X)
 The lamp (yellow-green line E) is connected to the controller terminal (Earth Wire E)
 ※ Note: Before wiring, please make sure that the circuit breaker switch is down

7. Failure analysis and elimination

Common fault analysis and exclusion table

Fault phenomenon	Cause Analysis	Method of exclusion	Remarks
light is not on	Poor contact or disconnection of input wire connection	Check the connection status	
	The input wire and the lamp wire are connected to the fire and the neutral wire.	Check the connection line fire and neutral line according to the wiring diagram of the manual.	

8. Maintenance

Every six months or one anniversary, it is necessary to clean the lampshade. The cleaning requires a soft cleaning tool. A rigid cleaning tool cannot be used to avoid the scratching lamp cover (plastic material).

9. Packaging/Storage

(1) The lamp packaging has a single package and four packs according to actual needs. The outer package is made of 5-layer corrugated paper box with a thickness greater than 5mm, which is protected by anti-collision, shockproof and anti-stress pearl cotton.

(2) Each box contains an instruction manual, a product qualification certificate, and a factory inspection report.

(3) The luminaires with packaging shall be stored in an environment where there is no change in ventilation, drying and temperature difference.

10. Contact information

HUNAN CHENDONG TECH CO., LTD

Address:#4, XinCheng Science and Technology Park, West of Yuelu road to Wanglong road, Yuelu district, Changsha city, Hunan province, China

Tel: +86-0731-85563265 +86-0731-85563165

Fax: +86-0731-85563365

E-mail: Sales@chendongtech.com